

# A new method for drying out low pitched cold deck roofs.



Bygge- og Miljøteknik A/S  
[www.byggeteknik.com](http://www.byggeteknik.com)

Niels Peter Kloch  
M.sc. Civ.Eng  
npk@byggeteknik.com

# Ventilated Cold Deck Roof Prefab and In situ

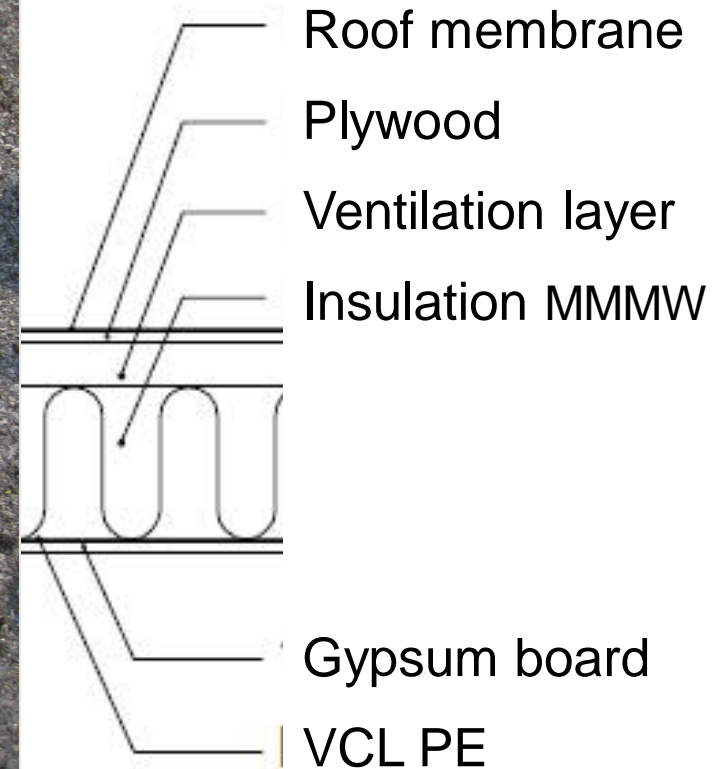
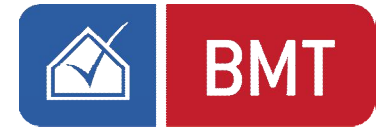

# Warm Deck Roof In situ

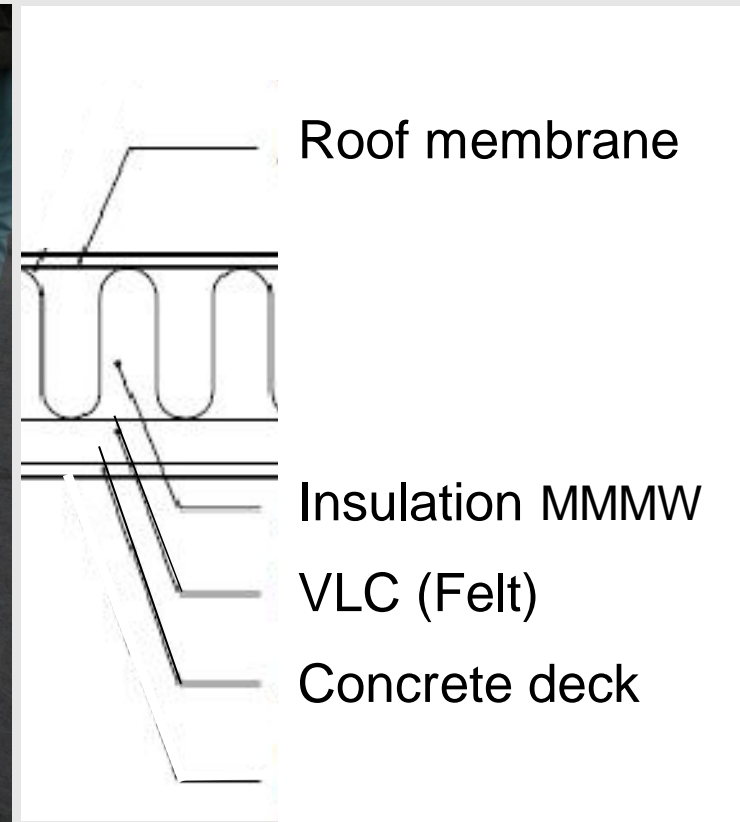
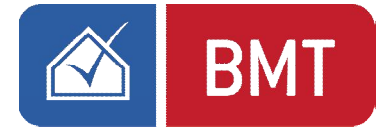

# Moist air

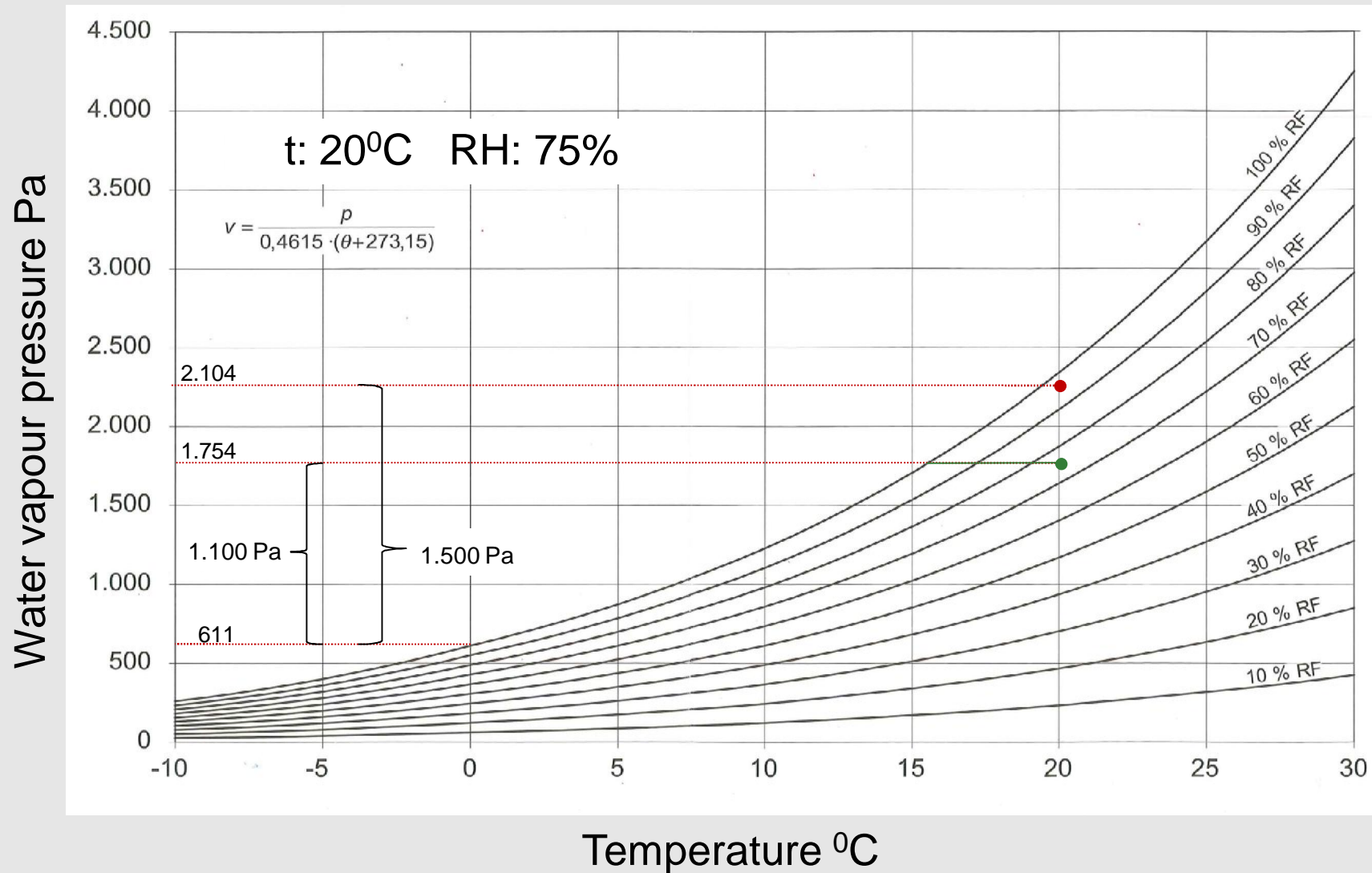

# Diffusion



Material	Z-value/m GPa m <sup>2</sup> s/kg
----------	--------------------------------------

Air

5,5

dP = 1.100 Pa

MMMF, light

6

MMMF, high density.

9

Expanded polystyrene  
(20 kg/m<sup>3</sup>)

250-350

Expanded polystyrene  
(32 kg/m<sup>3</sup>)

650-1500



# Test Roof Component

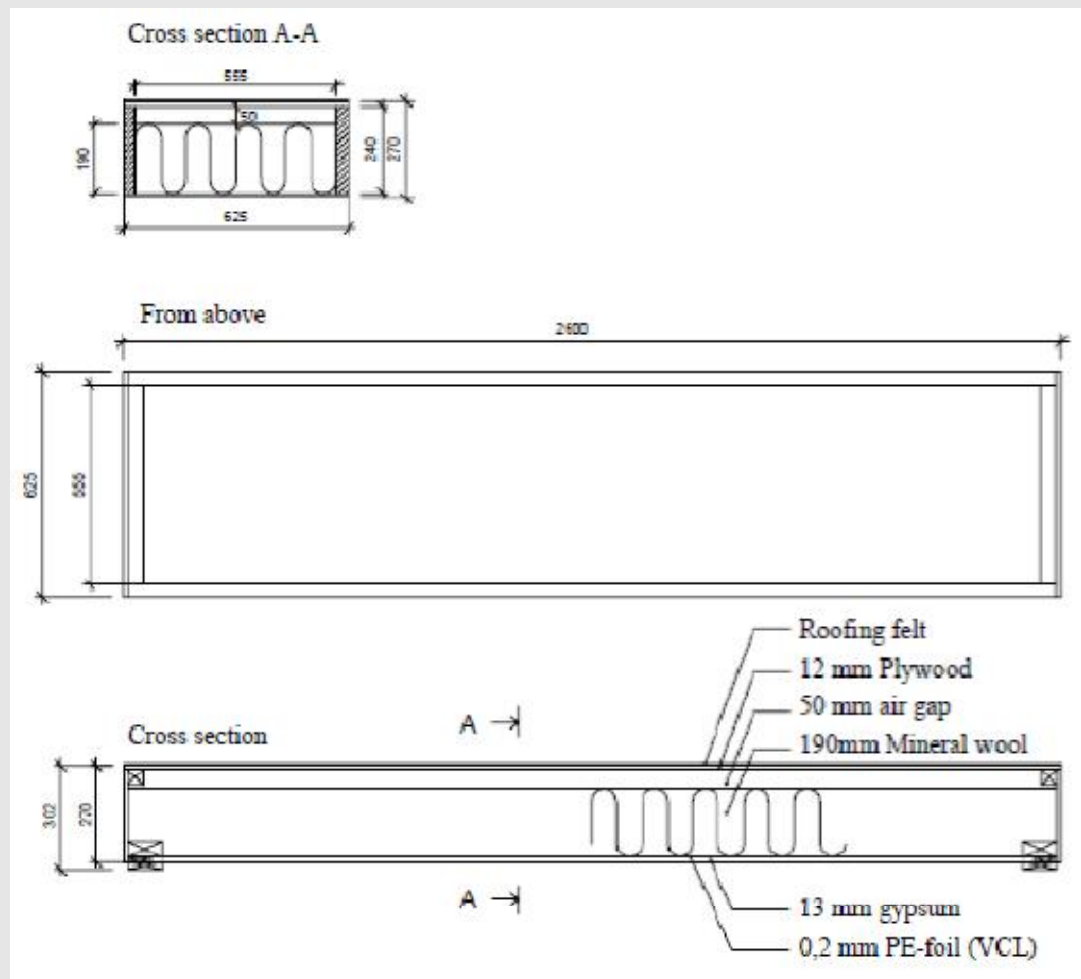

# Test Roof Component Measuring points

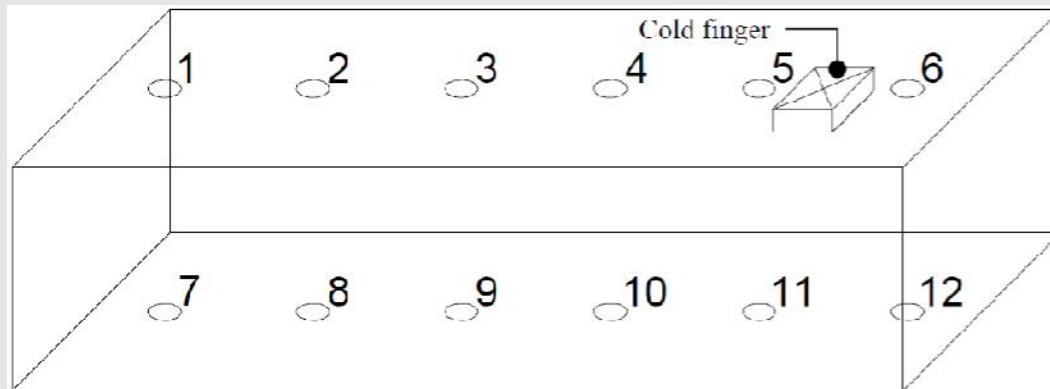

The "Cold finger" is installed between measuring point 5 and 6.

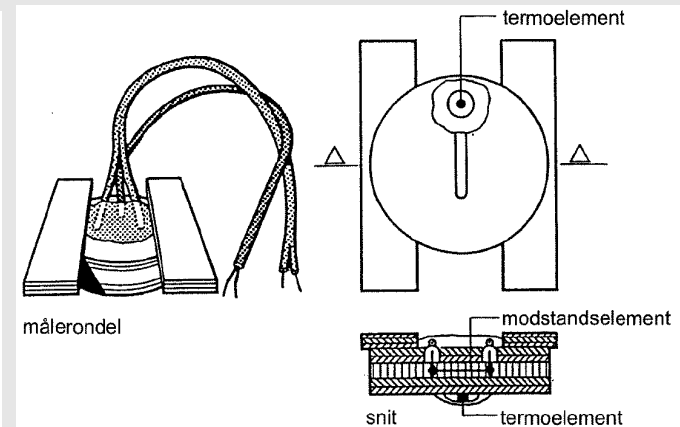
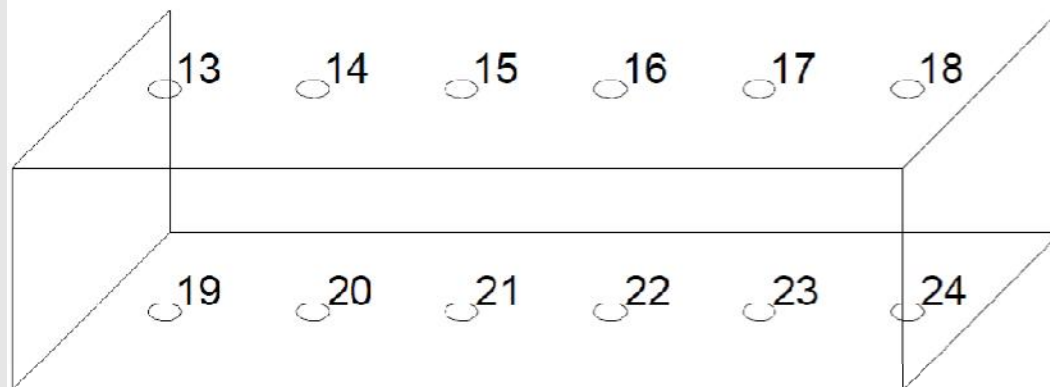

BM - Fugtmålerondel



Dr. Neergaards Vej 15  
DK-2320 Hørsholm  
Tlf. (+45) 45 66 29 22 • Fax (+45) 45 66 49 22 •  
www.bmtinstruments.com • email: info@bmtinstruments.com

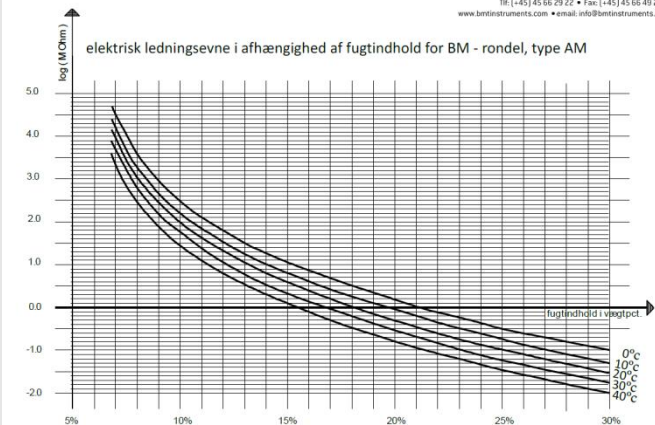

# Test Roof Component





# Test Roof Component “Cold finger”

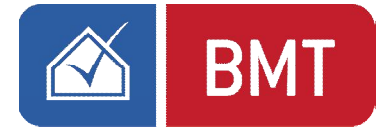

12 v DC standard cooling cabinet



# Results

## Test Roof Component

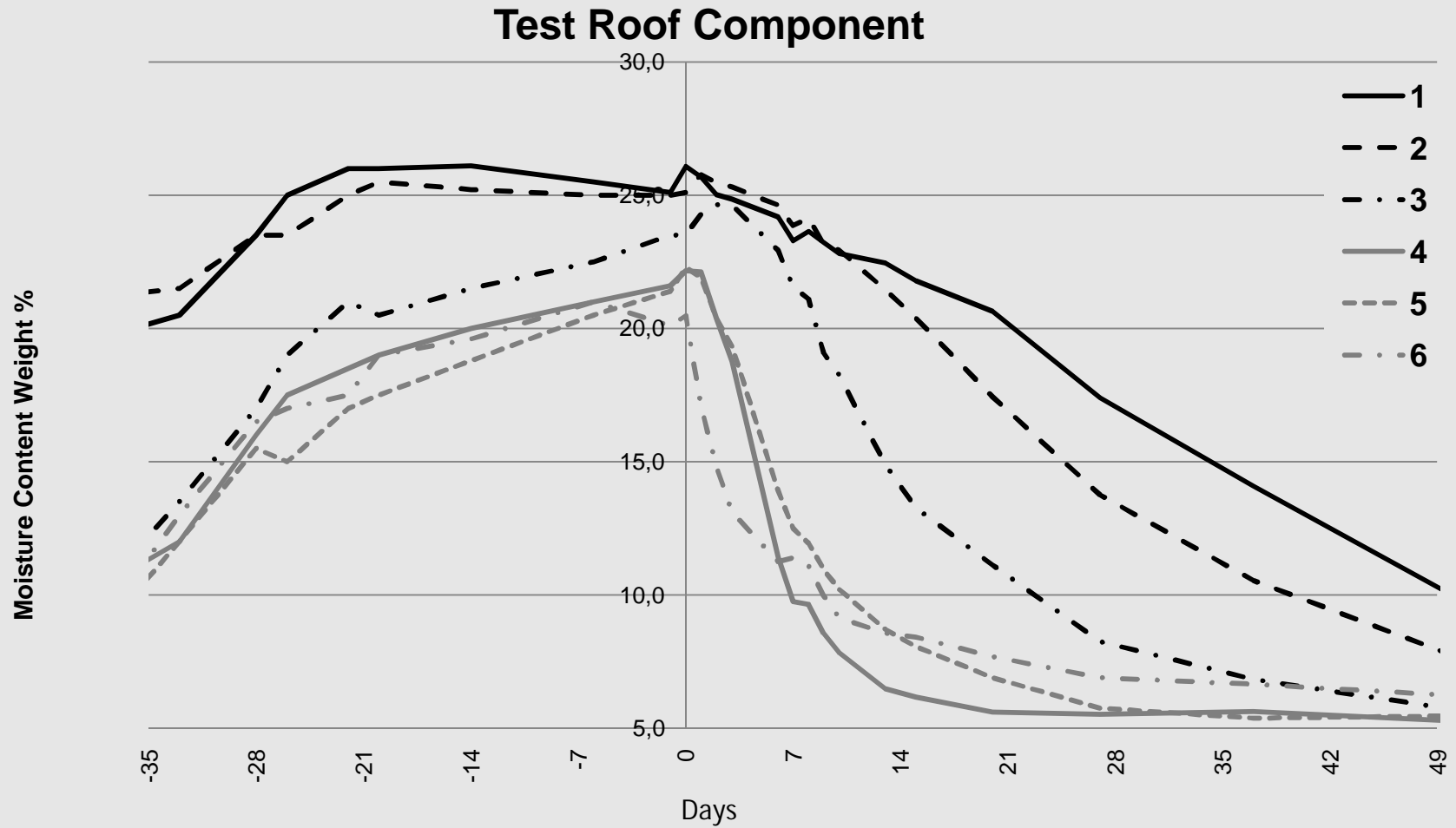

# Results

## Test Roof Component

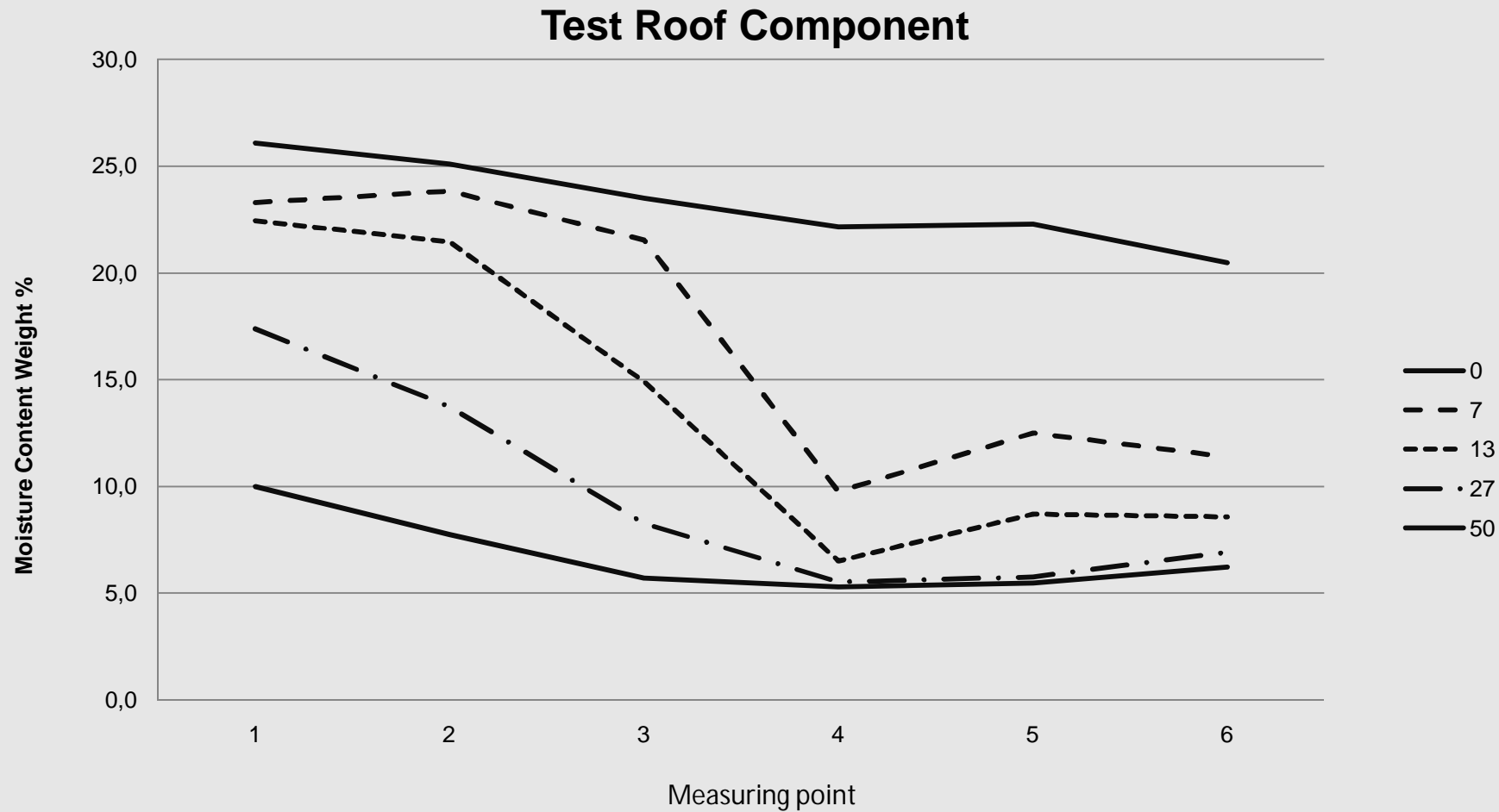

# Results

## Reference Roof Component

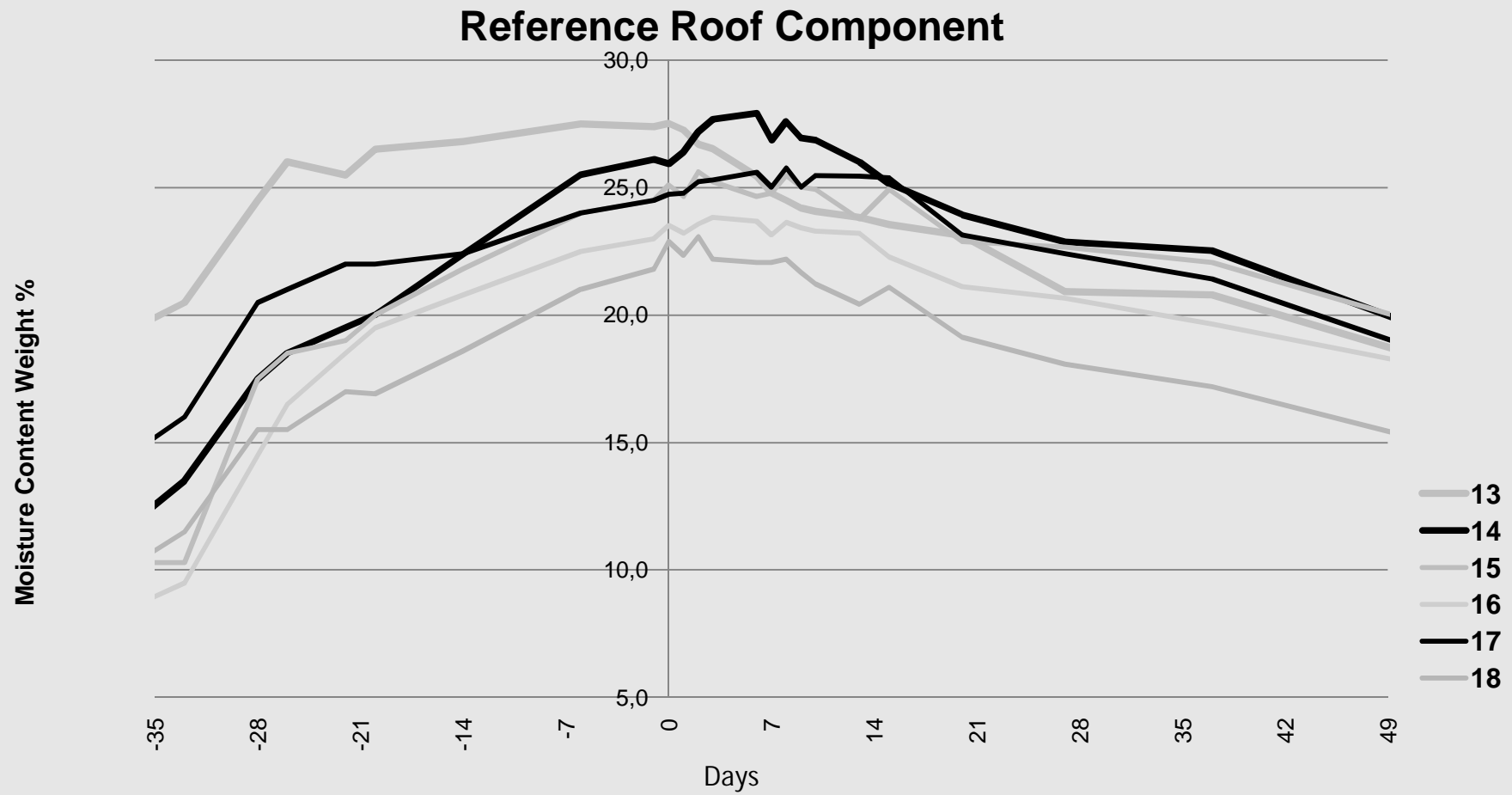

# Results



## Roof Components Bottom

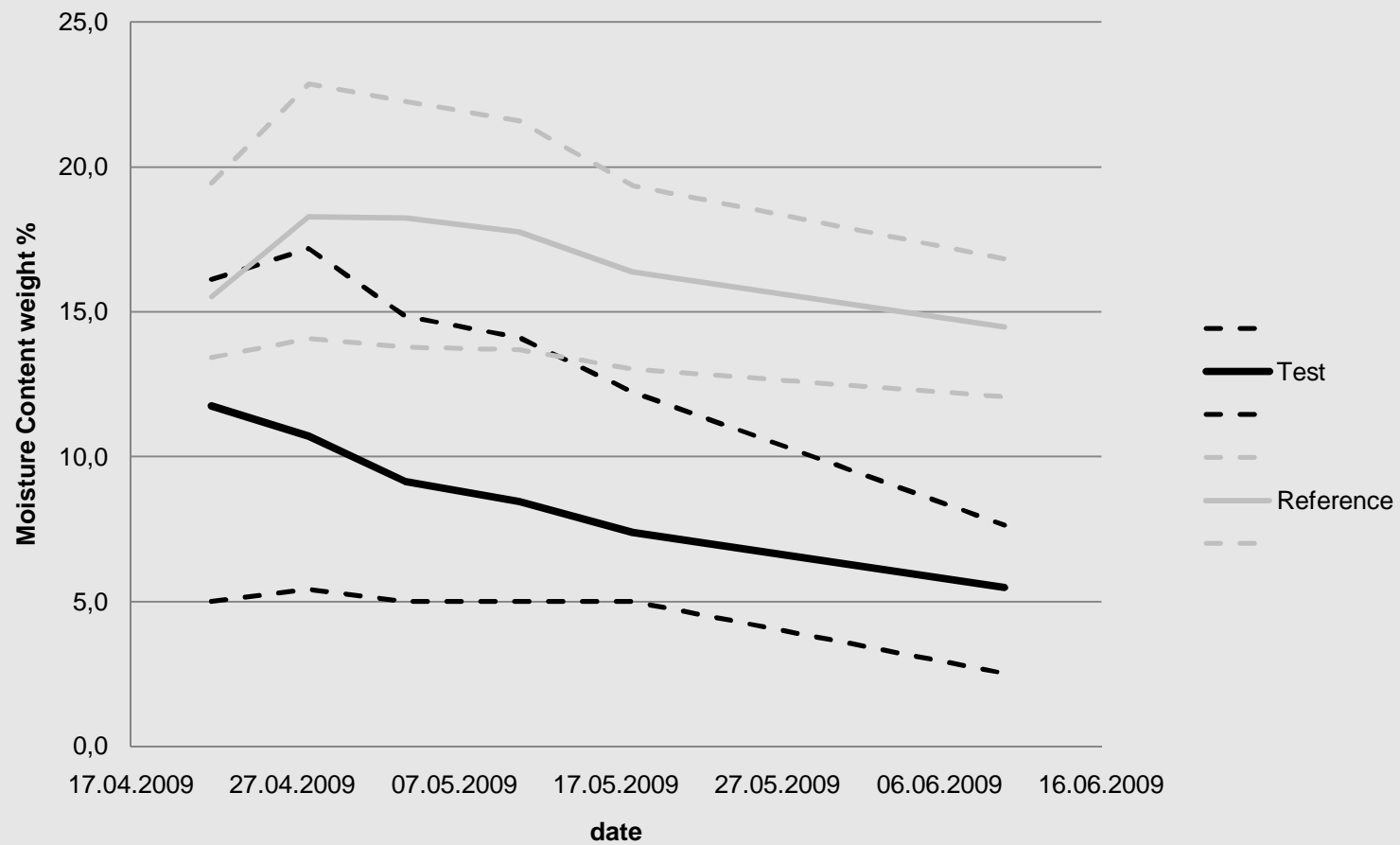



# Discussion

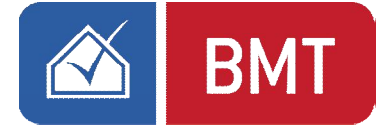

Diffusion – takes a long a time

Moisture profiles

Evacuation of condensed moisture

Costs

Cheap to produce

Easy installation (12V)

Running costs

Low power consumption

(15 W compared to 1KW)

No ventilation.

Solar cell

Test dP: 1.100 – 1.500 Pa

80°C 75% RH: 35.500 Pa

25°C 100% RH: 3.200 Pa

dP : 32.300 Pa

# Conclusion

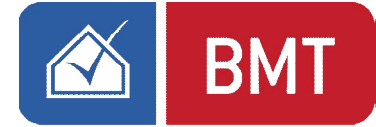

- Conclusion
  - Drying out under laboratory conditions is demonstrated for a cold deck roof
- Next step
  - Demonstration project in the field
  - Test on warm deck roofs
  - Test in attics
  - Under flooring and other cavities

# A new method for drying out low pitched cold deck roofs.

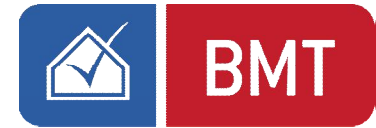

Bygge- og Miljøteknik A/S

[www.byggeteknik.com](http://www.byggeteknik.com)

Niels Peter Kloch M.sc. Civ.Eng

[npk@byggeteknik.com](mailto:npk@byggeteknik.com)